



WALK-IN ACCESS DOOR

Models AD-K, AD2-K and AD4-K

KEES access doors provide safe, easy walk-through access to ductwork and HVAC housings. Heavy-duty construction, double-wall insulated doors, compression handles and closed-cell neoprene gasketing maintain the integrity of the ductwork while providing convenient access wherever it is required. Selection includes low-pressure and high-pressure. Also, available with 1", 2" and 4" thick insulation.



MODEL AD-K
STANDARD OPEN OUTWARD CONSTRUCTION

STANDARD SIZES

WIDTH X HEIGHT
18 X 36
18 X 48
18 X 54
18 X 60
18 X 72
18 X 84
18 X 96
24 X 48
24 X 54
24 X 60
24 X 72
24 X 84
24 X 96
30 X 60
30 X 72
30 X 84
30 X 96
36 X 60
36 X 72
36 X 84
36 X 96
48 X 36
48 X 48
48 X 54
48 X 60
48 X 72
48 X 84
48 X 96

Two Panel Doors required for any widths over 48" wide.

Maximum single panel door is 48"W x 96"H

Other sizes available upon request.



WALK-IN ACCESS DOOR

Models AD-K, AD2-K and AD4-K



**MODEL AD-K-IN
IN SWING CONSTRUCTION**

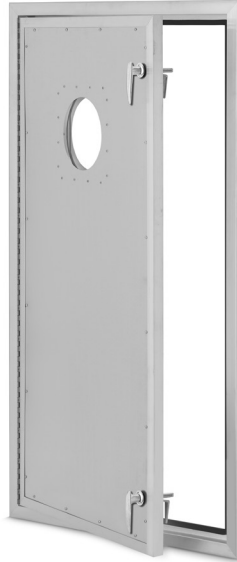

**MODEL ADG-K
WITH OPTIONAL VIEW PORT**

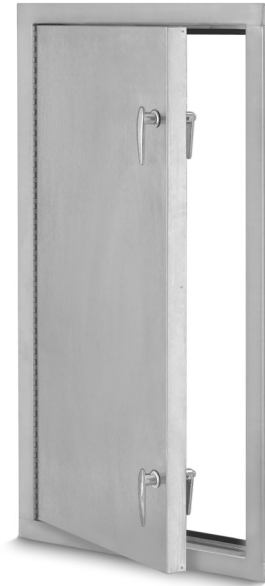

**MODEL AD2-K
2" THICK**

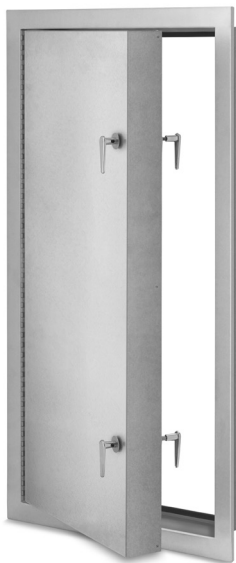

**MODEL AD4-K
4" THICK**



MODEL AD2-K TWO PANEL



WALK-IN ACCESS DOOR

Model AD-K

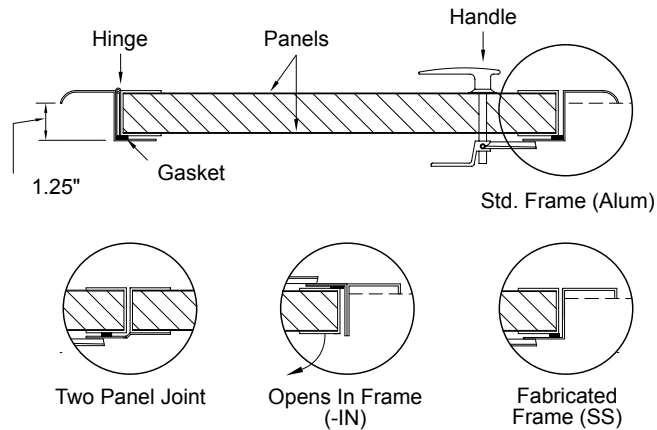
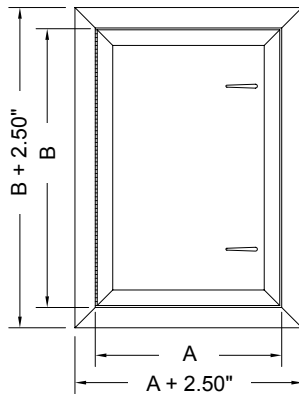

QTY	SIZE A X B	DUCT OPENING	NUMBER OF LATCHES			HINGE LOCATION (LEFT OR RIGHT)*
			(STD)	(-HP)	(TWO PANEL)	
	18 X 36	18.25 X 36.25	2	2	N/A	
	18 X 48	18.25 X 48.25	2	3	N/A	
	18 X 54	18.25 X 54.25	3	3	N/A	
	18 X 60	18.25 X 60.25	3	3	N/A	
	18 X 72	18.25 X 72.25	3	3	N/A	
	24 X 36	24.25 X 36.25	2	4	N/A	
	24 X 48	24.25 X 48.25	2	5	N/A	
	24 X 54	24.25 X 54.25	3	5	N/A	
	24 X 60	24.25 X 60.25	3	5	N/A	
	24 X 72	24.25 X 72.25	3	5	N/A	
	30 X 60	30.25 X 60.25	5	5	N/A	
	30 X 72	30.25 X 72.25	5	5	N/A	
	30 X 84	30.25 X 84.25	5	***	N/A	
	30 X 96	30.25 X 96.25	5	***	N/A	
	36 X 60	36.25 X 60.25	5	5	N/A	
	36 X 72	36.25 X 72.25	5	5	N/A	
	36 X 84	36.25 X 84.25	5	***	N/A	
	36 X 96	36.25 X 96.25	5	***	N/A	
	48 X 48	48.25 X 48.25	5	***	N/A	
	48 X 54	48.25 X 54.25	5	***	6	
	48 X 60	48.25 X 60.25	5	***	6	
	48 X 72	48.25 X 72.25	5	***	6	
	48 X 84	48.25 X 84.25	6	***	7	
	48 X 96	48.25 X 96.25	6	***	7	

SPECIFICATIONS

- 14-gauge door frame**
- 24-gauge door panels**
- Fiberglass insulation
- Neoprene gasket
- Handles work from outside & inside
- Piano hinge
- Mill finish

Note: Hinge mounted on "B" side

** Standard material: extruded aluminum frame and galvanized steel panels

MATERIAL

- Aluminum / Galvanized Steel (Std.)
- Aluminum
- 304 SS
- 316 SS

PRESSURE RATING

- 4.5" w.g. (Std.)
- 10" w.g. (-HP)

*** Use AD2-K-HP

OPTIONAL CONSTRUCTION

- Inswing Construction (-IN)
- Stainless Steel "T" Handles
- Two Panel Door Construction

OPTIONAL VIEW PORT*

- Plexiglass
- Lexan
- Laminated Safety Glass

* If view port is included, must advise left or right side hinge, facing door from outside.

To maintain our policy of continuous product development, we reserve the right to change prices, specifications, ratings, and dimensions without notice or obligation.

Project/Location		KEES INCORPORATED 400 South Industrial Drive Elkhart Lake, WI 53020 Ph: 920.876.3391 F: 920.876.3065 www.kees.com	
Engineer/Architect			
Contractor			
Representative			
		Date	



WALK-IN ACCESS DOOR

Models AD2-K & AD4-K

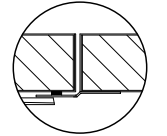
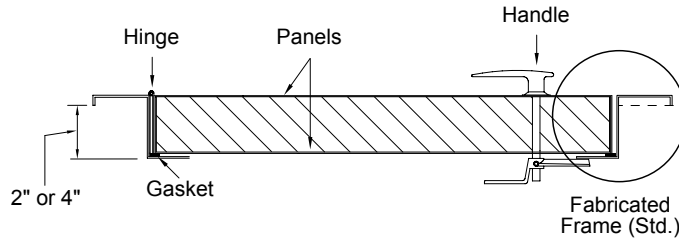
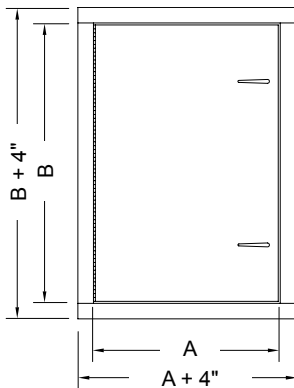

Two Panel Joint

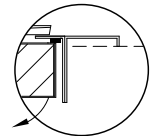

Opens In Frame (-IN)

QTY	SIZE A X B	DUCT OPENING	NUMBER OF LATCHES			HINGE LOCATION (LEFT OR RIGHT)*
			(STD)	(-HP)	(TWO PANEL)	
	18 X 36	18.25 X 36.25	2	2	N/A	
	18 X 48	18.25 X 48.25	2	3	N/A	
	18 X 54	18.25 X 54.25	2	3	N/A	
	18 X 60	18.25 X 60.25	2	3	N/A	
	18 X 72	18.25 X 72.25	2	3	N/A	
	24 X 36	24.25 X 36.25	2	4	N/A	
	24 X 48	24.25 X 48.25	2	5	N/A	
	24 X 54	24.25 X 54.25	2	5	N/A	
	24 X 60	24.25 X 60.25	2	5	N/A	
	24 X 72	24.25 X 72.25	2	5	N/A	
	30 X 60	30.25 X 60.25	2	5	N/A	
	30 X 72	30.25 X 72.25	2	5	N/A	
	30 X 84	30.25 X 84.25	3	5	N/A	
	30 X 96	30.25 X 96.25	3	5	N/A	
	36 X 60	36.25 X 60.25	2	5	N/A	
	36 X 72	36.25 X 72.25	2	5	N/A	
	36 X 84	36.25 X 84.25	3	5	N/A	
	36 X 96	36.25 X 96.25	3	5	N/A	
	48 X 48	48.25 X 48.25	2	5	5	
	48 X 54	48.25 X 54.25	2	5	6	
	48 X 60	48.25 X 60.25	2	5	6	
	48 X 72	48.25 X 72.25	3	5	6	
	48 X 84	48.25 X 84.25	3	6	7	
	48 X 96	48.25 X 96.25	3	6	7	

* If view port is included, must advise left or right side hinge, facing door from outside.

To maintain our policy of continuous product development, we reserve the right to change prices, specifications, ratings, and dimensions without notice or obligation.

SPECIFICATIONS

- 14-gauge door frame
- 18-gauge door panel
- Fiberglass insulation
- Neoprene gasket
- Handles work from outside & inside
- Piano hinge
- Mill finish

Note: Hinge mounted on "B" side

MATERIAL

- Galvanized Steel (Std.)
- Aluminum
- 304 SS
- 316 SS

INSULATION

- 2" Thick (AD2-K)
- 4" Thick (AD4-K)

PRESSURE RATING

- 4.5" w.g. (Std.)
- 10" w.g. (-HP)

OPTIONAL CONSTRUCTION

- Inswing Construction (-IN)
- Stainless Steel "T" Handles
- Two Panel Door Construction

OPTIONAL VIEW PORT*

- Plexiglass
- Lexan
- Laminated Safety Glass

Project/Location		KEES INCORPORATED 400 South Industrial Drive Elkhart Lake, WI 53020 Ph: 920.876.3391 F: 920.876.3065 www.kees.com
Engineer/Architect		
Contractor		
Representative		Date